

BUY KIT 816037

9	1	10	891110	O-RING, 15/64 OD x 7/64 ID x 1/16 THICK	
7	1	1	891049	POWER BIT, 2.5mm HEX, 1/4" [6.35] HEX SHANK	
6	1	3	891048	BUSHING, #30 (.1285") [3.263] ID x 1/4" [6.35] OD	
5	1	9	890866	SCREW, M3x 10mm, SOCKET HEAD CAP 2.5mm FEMALE HEX	
4	4	12	891047	BELLEVILLE, DISC SPRING, 1.25 [3.175] ID x .250 [6.35] OD	
3	2	6	891046	WASHER, METRIC, M3, THICK	
ITEM	QTY REQ'D	MULTI PAK	QTY	PART NO.	DESCRIPTION

RUNDOWN FIXTURE 101 ASSEMBLY (816318 IF BOUGHT AS AN ASSEMBLY)

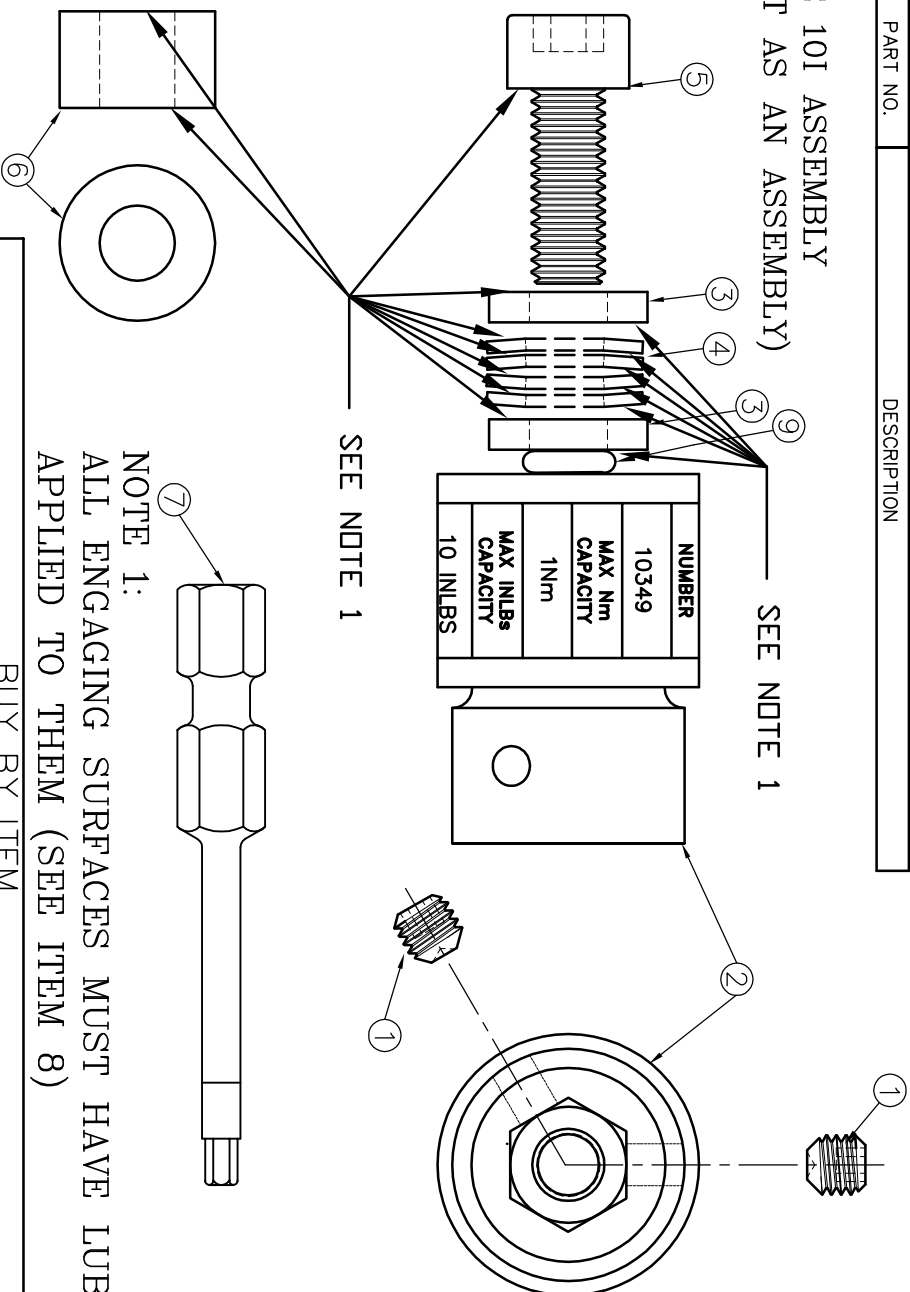

SEE NOTE 1

SEE NOTE 1

NOTE 1:

ALL ENGAGING SURFACES MUST HAVE LUBRICANT APPLIED TO THEM (SEE ITEM 8)

BUY BY ITEM

BUY BY ITEM					
ITEM	QTY REQ'D	MULTI PAK	QTY	PART NO.	DESCRIPTION
8	1	1		816034	MULTI PAK, MOLY GREASE, 1 POUND CAN
2	1	1		816318	MULTI PAK, WELDMENT, RUNDOWN 1 Nm FIXTUREW/ 1/4 [6.35] FEMALE HEX
1	2	10		816840	MULTI PAK, SCREW SET HEX CUP PT 8-32X/8 (INCLUDES BAG 820095 & LABEL 857000)



STURTEVANT RICHMONT
TORQUE MEASUREMENT SYSTEMS
DIVISION OF RYeson CORPORATION

THIS PRINT AND ALL INFORMATION APPEARING THEREON IS THE PROPERTY OF "STURTEVANT/RICHMONT". NEITHER THE PRINT NOR THE INFORMATION THEREON MAY BE REPRODUCED OR USED IN ANY MANNER WHATSOEVER OR DIVULGED TO ANY OTHER PERSON UNLESS SPECIFICALLY AUTHORIZED BY "STURTEVANT/RICHMONT".

PART DESCRIPTION
RUNDOWN FIXTURE 101
(1Nm), 1/4 FEMALE HEX

DIAGRAM NO. & REV.
10349-E